

CERTIFIED RECORD OF LAND CORNER MONUMENTATION

D

History of original corner establishment:

The original corner was set in 1884 by Henry W. Cooke.

Set a basalt stone 20x10x10 ins. 15 ins in the ground for 1/4 sec cor marked 1/4 on the W. face from which

A pine 44 ins diam bears S 60 E 139 lks dist marked 1/4SBT. No other tree within limits. dug pits N & S of stone 5 1/2 ft dist and raised a mound of Earth alongside.

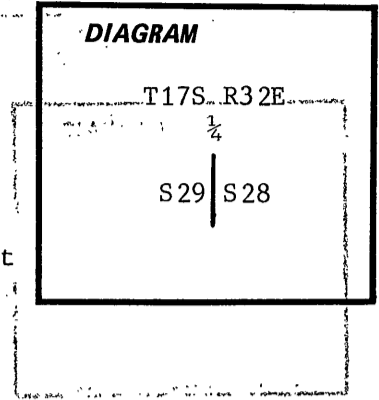

Description of corner evidence found:

Found a 17x8x6 stone marked 1/4 on the West face.

A 36" Ponderosa Pine bears S 60 1/2 E, 93.6 feet scribed 1/4S in an opened face.

Description of monument and accessories established to perpetuate the original location of this corner:

Set a 3 1/2" x 30" aluminum monument 22" in the ground in a mound of stone. Placed the original stone in the mound. CAP MARKED

11" Ponderosa Pine bears N 53 1/2 E, 5.2 feet scribed 1/4S28BT.
16" Ponderosa Pine bears N 88 W, 54.2 feet scribed 1/4S29BT.

T17S R32E
1/4
S29 S28
PLS 1918
1985

Bearing trees have a 3/4" brass washer marked LS 1918 attached between the B & T. Painted faces and bands red and attached Attention signs and BT tags. Bearing tree measurements were made to the center of the trees.

Set a steel fence post with Attention sign South 3 feet.

Work performed 13 May 1985
Witness: Louise H. Parsons

Tyler B. Parsons, PLS 1918
1915 SE Stone Street
Corvallis, OR 97333
(503) 752-7515

Road Cadastral Survey, Cont No 53-04H1-4-9665N

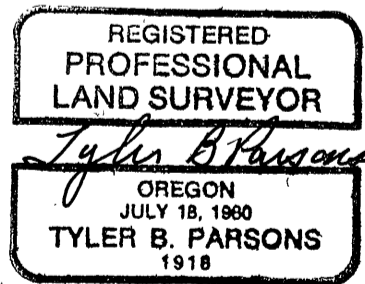

Office of _____
 State of _____
 Office of _____ County of _____
 State of _____ I hereby certify that the within instrument was filed in this office
 for record on the _____ day of _____, 1985
 _____ by _____
 (COUNTY OFFICIAL) (DEPUTY)